

PRECAUTIONARY STATEMENTS

HAZARD TO HUMAN AND DOMESTIC ANIMALS

Harmful if inhaled, swallowed, or absorbed through skin. Causes moderate eye irritation. Avoid breathing dust. Avoid contact with skin, eyes or clothing. Wash hands thoroughly with soap and water after handling and before eating, drinking, chewing gum, using tobacco or using the toilet. Repeated exposure to high concentrations of microbial proteins can cause allergic sensitization. Prolonged or frequently repeated skin contact may cause allergic reactions in some individuals. Remove and wash contaminated clothing before reuse. Obtain medical attention if irritation persists. Avoid contamination of food or feedstuffs.

PERSONAL PROTECTIVE EQUIPMENT (PPE)

All applicators and other handlers must wear:

- Long-sleeved shirt and long pants;
- Water proof gloves
- Shoes plus socks

Follow the manufacturer's instructions for cleaning/maintaining PPE. If no such instructions for washables exist, use detergent and hot water. Keep and wash PPE separately from other laundry.

In addition, all applicators and handlers must wear a NIOSH-approved particulate respirator with any N, R, or P filter (NIOSH approval number prefix TC-84A); or a NIOSH-approved powered air purifying respirator with an HE filter (NIOSH approval number prefix TC-21C).

USER SAFETY RECOMMENDATIONS

Users should:

- Wash hands before eating, drinking, chewing gum, using tobacco, or using the toilet.
- Remove clothing/PPE immediately if pesticide gets inside. Then wash thoroughly and put on clean clothing.
- Remove PPE immediately after handling this product. Wash the outside of gloves before removing. As soon as possible, wash thoroughly and change into clean clothing.

ENVIRONMENTAL HAZARDS

This product is toxic to fish and aquatic invertebrates. Do not apply directly to areas where surface water is present or to intertidal areas below the mean high water mark. Do not contaminate water by cleaning of equipment or disposal of equipment washwaters. Application of this product is prohibited directly into sewers or drains, or to any area like a gutter where drainage to storm sewers, water bodies, or aquatic habitat can occur. Do not allow the product to enter any drain during or after application.

This product is highly toxic, and may be pathogenic to bees exposed to direct treatment on blooming crops or weeds. Do not apply this product or allow it to drift to blooming crops or weeds while bees are actively visiting the treatment area.

STORAGE AND DISPOSAL

Do not contaminate water, food, or feed by storage or disposal.

PESTICIDE STORAGE: Keep this product in its tightly closed original container when not in use. Store in a cool, dry, well-ventilated (preferably locked) area that is inaccessible to children and animals. Store this product in a place away from strong bases, strong acids, sources of ignition and direct sunlight.

PESTICIDE DISPOSAL: For waste materials following 4-week treatment interval (e.g., disposal of used netting with attractants/used water with attractants at time of IN2MIX® refill replacement): Dispose of used netting in a sanitary landfill, or by other procedures approved by state and local authorities; Dispose of used water with attractants by pouring out of IN2CARE® trap onto the ground, and not near a water source. Prevent entry of used water into sewers, gutters, or drains, or any area where drainage to storm sewers, water bodies, or aquatic habitat can occur. Notify authorities if liquid enters sewers or public waters.

CONTAINER HANDLING: Shake unopened IN2MIX® packet to assure that actives stick to netting. Open packet and place one IN2MIX® pesticide-treated netting on the floater. Completely empty remaining contents (powder and odor tablets) into IN2CARE® trap by shaking and tapping sides and bottom to loosen clinging particles. When completely empty, dispose of empty packets in trash or in a sanitary landfill, or by other procedures approved by state and local authorities.

Doc ID
561830



In2Mix®

ACCEPTED
FOR REGISTRATION

May 24, 2019

Refills for Use in the In2Care® Trap

New York State Department
of Environmental Conservation
Division of Materials Management
Pesticide Product Registration

For use to control Aedes species of Mosquitoes that may transmit Zika, Chikungunya, and Dengue Fever

THIS PRODUCT IS NOT FOR RETAIL SALE

Active Ingredients:

Pyriproxyfen (CAS No. 95737-68-1)	% w/w
Beauveria bassiana strain GHA* (CAS No. 63428-82-0)	74.03%
Other Ingredients:	10.00%
Total:	15.97%
	100.00%

* Contains not less than 4.5 X 10⁹ viable spores/gm.

KEEP OUT OF REACH OF CHILDREN

CAUTION

READ ALL LABEL DIRECTIONS COMPLETELY BEFORE USE

FIRST AID

If Inhaled

Move person to fresh air. If person is not breathing, call 911 or an ambulance, then give artificial respiration, preferably by mouth-to-mouth, if possible. Call a poison control center or doctor for further treatment advice.

If Swallowed

Call a poison control center or doctor immediately for treatment advice. Have a person sip a glass of water if able to swallow. Do not induce vomiting unless told to do so by the poison control center or doctor. Do not give anything by mouth to an unconscious person.

If on Skin

Take off contaminated clothing. Rinse skin immediately with plenty of water for 15-20 minutes. Call a poison control center or doctor for treatment advice.

If in Eyes

Hold eye open and rinse slowly and gently with water for 15-20 minutes. Remove contact lenses, if present, after the first 5 minutes, then continue rinsing eye. Call a poison control center or doctor for treatment advice.

HOT LINE NUMBER Have the product container or label with you when calling a poison control center or doctor or going for treatment. For additional information on this pesticide product (including health concerns, medical emergencies or pesticide incidents), you may call the National Pesticide Information Center at 1-800-858-7378, from 8:00 a.m. to 12:00 p.m. Pacific Time, Monday through Friday. After 12:00 p.m. Pacific Time on weekdays, and during the weekend, call the poison control center at 1-800-222-1222.

NOTICE: Buyer and user assume all risks and liability of use, storage and/or handling of this product not in accordance with the terms of this label.

BUYER GUARANTEE LIMITED TO LABEL CLAIMS

Manufactured by:

In2Care BV, Marijkeweg 22,
6709 PG Wageningen, NL

EPA Reg. No.: 91720-1, EPA Est. No.: 7319-NLD-1



Net Weight:

50g (1.76 ounces)
100 refills x 0.5g each
(0.018 ounces)

Batch N°:

12CT.1.US.1015

DIRECTIONS FOR USE

It is a violation of Federal law to use this product in a manner inconsistent with its labeling.

READ ALL LABEL DIRECTIONS COMPLETELY BEFORE USE

FOR OUTDOOR USE ONLY

ASSEMBLY

Assemble the plastic IN2CARE® trap as directed in the en manual. Fill the base with 4 to 5 quarts (3.5–4.5 liters) of clean water. Place one IN2MIX® pesticide-treated netting on the floater below. Empty the remaining contents (powder and odor tablet) into the water. Use one IN2MIX® packet per trap every 4 weeks when adults are active. DO NOT allow people or pets to contact the pest

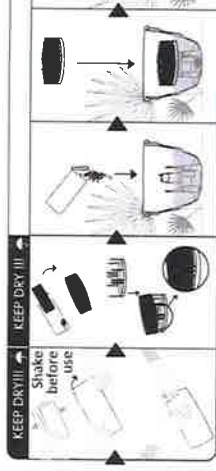

PLACEMENT

Place the activated IN2CARE® trap outside on the ground shaded location. Avoid locations with continuous direct sunlight. Optimal coverage, place at least 1 trap every 4,300 sq. ft (meters), or at least 10 traps per acre. Do not exceed 15 traps

TO REFILL

Re-visit each IN2CARE® trap every 4 weeks. Remove the lid of the floater. Dispose of the waste materials (netting and floater) in the Storage and Disposal section of this label. Fill to 5 quarts (3.5–4.5 liters) of clean tap water. Take a new IN2MIX® packet and repeat the assembly steps as described above.

HOW IT WORKS

IN2MIX® slowly kills adult Aedes spp. mosquitoes. Therefore, mosquitoes may not be found in the trap.

The Aedes spp. larvae that emerge from eggs laid inside the trap are killed by the growth regulator prior to transforming into pupae, eventually die.

After laying eggs, the adult female should be containing a growth regulator and slow acting adulticide so she can carry the regulator to other nearby breeding sites and should die within days following exposure to the adulticide.

For best results, remove/empty artificial water containers (pots, plastic cups, car tires, etc.) that serve as other breeding sites and use a registered mosquito larvicide to treat breeding sites that are removed or emptied.

Aedes spp. mosquitoes can have very specific breeding sites within certain locations. Check for the presence of live mosquito larvae inside the traps every 4 weeks. When continuously has zero or much fewer larvae when compared to nearby traps, the unattractive trap should be relocated to a nearby shaded location.

PYRIPROXYFEN	GROUP 7C	INSECTICIDE
<i>Beauveria bassiana</i> Strain GHA	GROUP UN	INSECTICIDE



Refills for use in the In2Care® Trap

For use to control *Aedes* species of Mosquitoes that may transmit Zika, Chikungunya and Dengue Fever

KEEP OUT OF REACH OF CHILDREN

CAUTION

READ ENCLOSED MANUAL FOR COMPLETE DIRECTIONS FOR USE

Active Ingredients:

Pyriproxyfen (CAS No. 95737-68-1)	% w/w
<i>Beauveria bassiana</i> strain GHA* (CAS No. 63428-82-0)	74.03%
Other Ingredients:	10.00%
Total	15.97%
	100.00%

* Contains not less than 4.5 X 10⁸ viable spores/gm.

FIRST AID

If Inhaled: Move person to fresh air. If person is not breathing, call 911 or an ambulance, then give artificial respiration, preferably by mouth-to-mouth, if possible. Call a poison control center or doctor for further treatment advice.

If Swallowed: Call a poison control center or doctor immediately for treatment advice. Have a person sip a glass of water if able to swallow. Do not induce vomiting unless told to do so by the poison control center or doctor. Do not give anything by mouth to an unconscious person.

If on Skin: Take off contaminated clothing. Rinse skin immediately with plenty of water for 15-20 minutes. Call a poison control center or doctor for treatment advice.

If in Eyes: Hold eye open and rinse slowly and gently with water for 15-20 minutes. Remove contact lenses, if present, after the first 5 minutes, then continue rinsing eye. Call a poison control center or doctor for treatment advice.

HOT LINE NUMBER Have the product container or label with you when calling a poison control center or doctor or going for treatment. For additional information on this pesticide product (including health concerns, medical emergencies or pesticide incidents), you may call the National Pesticide Information Center at 1-800-858-7378, from 8:00 a.m. to 12:00 p.m. Pacific Time, Monday through Friday. After 12:00 p.m. Pacific Time on weekdays, and during the weekend, call the poison control center at 1-800-222-1222.

Manufactured by:

In2Care BV, Marijkeweg 22,6709 PG Wageningen, NL
EPA Reg. No.: 91720-1, EPA Est. No.: 7319-NLD-1

Net Weight: 0.5g
(0.018 ounces)

Batch No.:
I2CT.1.US.1015



PRECAUTIONARY STATEMENTS

HAZARD TO HUMAN AND DOMESTIC ANIMALS

Harmful if inhaled, swallowed, or absorbed through skin. Causes moderate eye irritation. Avoid breathing dust. Avoid contact with skin, eyes or clothing. Wash hands thoroughly with soap and water after handling and before eating, drinking, chewing gum, using tobacco or using the toilet. Repeated exposure to high concentrations of microbial proteins can cause allergic sensitization. Prolonged or frequently repeated skin contact may cause allergic reactions in some individuals. Remove and wash contaminated clothing before reuse. Obtain medical attention if irritation persists. Avoid contamination of food or feedstuffs.

PERSONAL PROTECTIVE EQUIPMENT (PPE)

- All applicators and handlers must wear:
- Long-sleeved shirt and long pants;
 - Waterproof gloves; and
 - Shoes plus socks

Follow the manufacturer's instructions for cleaning/maintaining PPE. If no such instructions for washables exist, use detergent and hot water. Keep and wash PPE separately from other laundry. In addition, all applicators and handlers must wear a NIOSH-approved particulate respirator with any N, R, or P filter (NIOSH approval number prefix TC-84A); or a NIOSH-approved powered air purifying respirator with an HE filter (NIOSH approval number prefix TC-21C).

USER SAFETY RECOMMENDATIONS

- Users should:
- Wash hands before eating, drinking, chewing gum, using tobacco, or using the toilet.
 - Remove clothing/PPE immediately if pesticide gets inside. Then wash thoroughly and put on clean clothing.
 - Remove PPE immediately after handling this product. Wash the outside of gloves before removing. As soon as possible, wash thoroughly and change into clean clothing.

ENVIRONMENTAL HAZARDS

This product is toxic to fish and aquatic invertebrates. Do not apply directly to areas where surface water is present or to intertidal areas below the mean high water mark. Do not contaminate water by cleaning of equipment or equipment wash-waters. Application of this product is prohibited directly into sewers or drains, or to any area like a gutter where drainage to storm sewers, water bodies, or aquatic habitat can occur. Do not allow the product to enter any drain during or after application.

This product is highly toxic, and may be pathogenic to bees exposed to direct treatment on blooming crops or weeds. Do not apply this product or allow it to drift to blooming crops or weeds while bees are actively visiting the treatment area.

STORAGE AND DISPOSAL

Do not contaminate water, food, or feed by storage or disposal.

PESTICIDE STORAGE: Keep this product in its tightly closed original container when not in use. Store in a cool, dry, well-ventilated (preferably locked) area that is inaccessible to children and animals. Store this product in a place away from strong bases, strong acids, sources of ignition and direct sunlight.

PESTICIDE DISPOSAL: For waste materials following 4 week treatment interval (e.g., disposal of used netting with attractives/used water with attractants at time of IN2MIX® refill replacement): Dispose of used netting in a sanitary landfill, or by other procedures approved by state and local authorities. Dispose of used water with attractives by pouring out of IN2CARE® trap onto the ground, and not near a water source. Prevent entry of used water into sewers, gutters, or drains, or any area where drainage to storm sewers, water bodies, or aquatic habitat can occur. Notify authorities if liquid enters sewers or public waters.

CONTAINER HANDLING: Shake unopened IN2MIX® packet to assure that actives stick to netting. Open packet and place one IN2MIX® pesticide-treated netting on the floater. Completely empty remaining contents (powder and/or tablets) into IN2CARE® trap by shaking and tapping sides in and bottom to loosen clinging particles. When completely empty, dispose of empty packets in trash or in a sanitary landfill, or by other procedures approved by state and local authorities.



Contents



Refill package



Base



Lid



Floater



Time indicator cap

Assembly



Fill the base with 4 to 5 quarts (3.5 - 4.5 liters) of clean tap water. For placement details see other side of this sheet.



Shake the refill package thoroughly and open it by tearing at the notches. Gently take out the powder-coated piece of gauze.

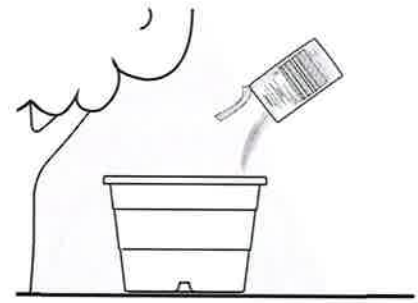

Empty the remaining contents (powder and odor tablets) of the refill package into the water of the trap. Avoiding the gauze from getting wet.

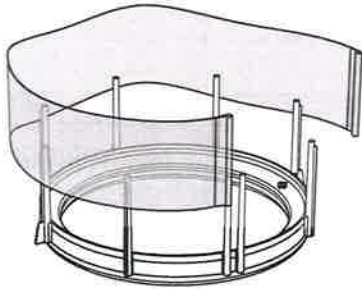

Slide the loop at the ending of the gauze over the pin as shown. Try not to touch the gauze extensively to avoid removal of the active powders.

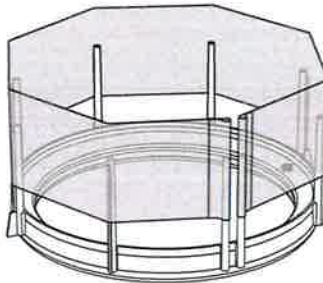

Wrap the gauze around the floater and slide the other gauze loop on the last pin as shown. Work your way around moving the gauze down at each pin.

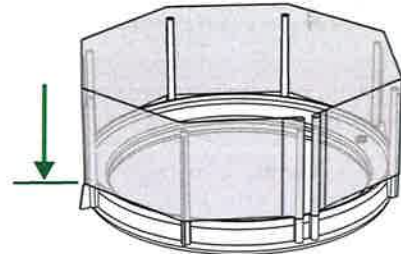

Push the gauze down the pins until it will go no further (where the bottom of the pin hits the circular rib). The rib will prevent the gauze from sliding too far.

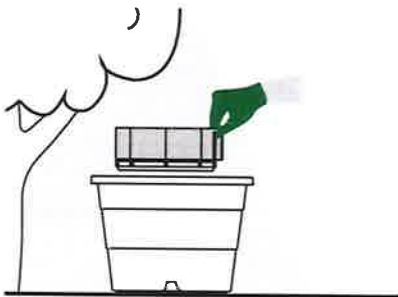

Put the gauze-carrying floater inside the trap by gently placing it over the central tube flat onto the water. Prevent the gauze from getting wet as water will degrade the powder.

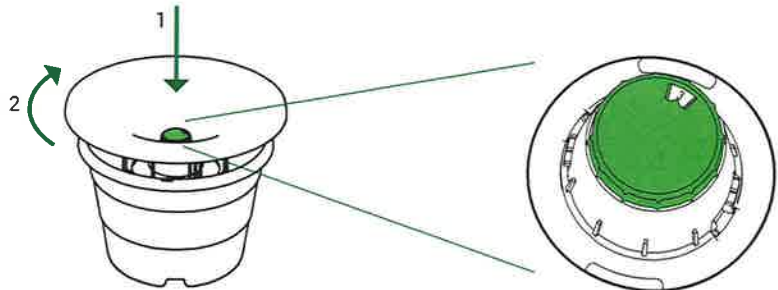

Place the lid on the central tube, push it down and turn it clockwise.

Turn the time indicator to the number of the current month as a service reminder.





Placement

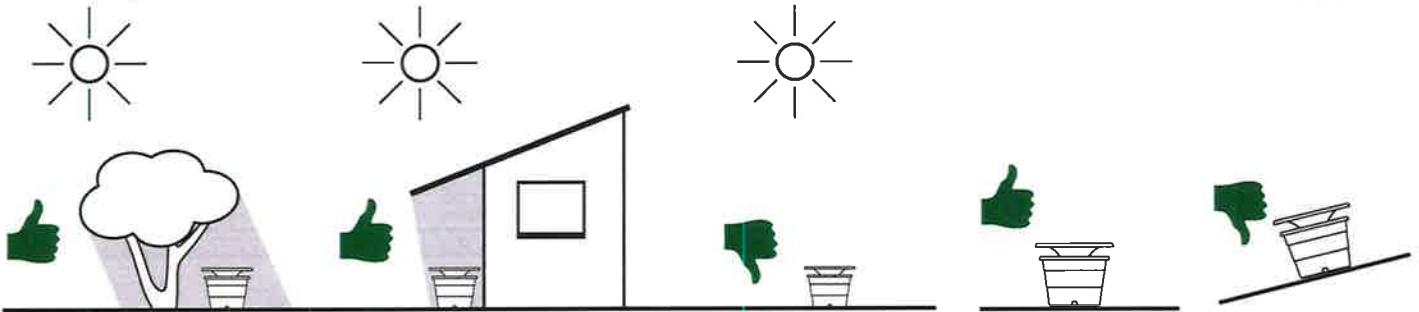

Place in a shady spot

Place on a level surface:

Recommendations

For an optimal efficacy of the activated In2Care Mosquito Trap, ensure high trap coverage (1 trap per 400m²/10-15 per acre) in the selected treatment area and remove other mosquito breeding sites as much as possible. Do not exceed 15 traps per acre.

For the results, remove and/or empty artificial water containers (flower pots, plastic cups, car tires, etc.) and natural breeding sites (puddles, tree holes etc.). Larger water bodies that cannot be removed or emptied should be (frequently) treated with appropriate mosquito larvicides.

We recommend outdoor trap placement on the ground in a level, shaded location, close to human habitation/houses.

In dry areas, check the water level inside the trap regularly and add more water when needed.



Evenly distribute traps over available space

Re-visit each trap every 4 weeks.

Maintenance

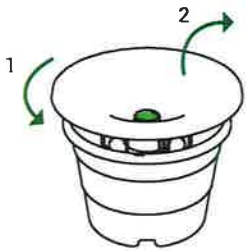

Remove the lid by turning it counter clockwise until the stop and lift it.

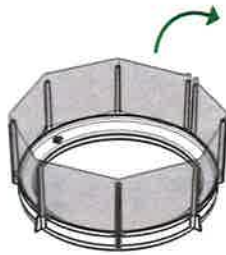

Take out the floater and dispose of the used netting and used water as indicated in the Storage and Disposal section of the label on the refill package.

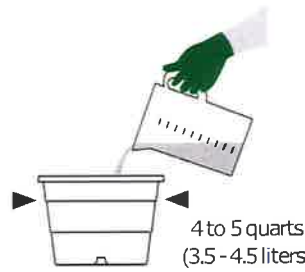

Remove leaves or other debris that may have fallen into the water and refill the trap with 4 to 5 quarts (3.5-4.5 liters) of clean tap water.



Take a new refill package and repeat the assembly steps as described on the other side of this manual.

When traps are disturbed by animals, stability can be improved by fixating the trap to the ground using a zip tie or the wire bracket, available separately from the distributor, which snaps onto the pot.

Fixating

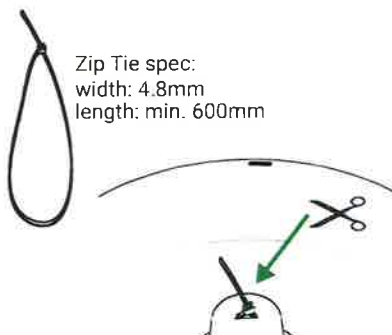

Zip Tie spec:
width: 4.8mm
length: min. 600mm

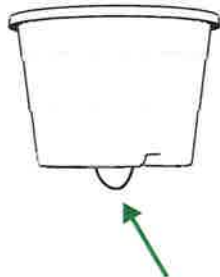

The loop can be tied to a

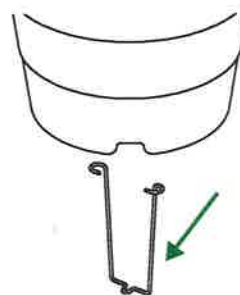

The wire bracket can be screwed

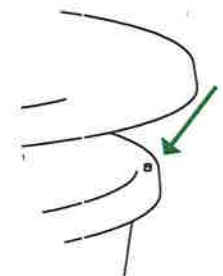

Another fixation option is to use the

SECTION 1: Identification of the substance/mixture and of the company/undertaking

1.1. Product identifier

Product form : Mixture
Product name : In2mix

1.2. Relevant identified uses of the substance or mixture and uses advised against

1.2.1. Relevant identified uses

Main use category : Professional use

1.2.2. Uses advised against

No additional information available

1.3. Details of the supplier of the safety data sheet

In2Care B.V.
Marijkeweg 22
6709 PG Wageningen - Netherlands
T +31 317 769018
info@in2care.org - www.in2care.org

1.4. Emergency telephone number

Emergency number : Hot line number have the product container or label with you when calling a poison control center or doctor or going for treatment. For additional information on this pesticide product (incl. health concerns, medical emergencies or pesticide incidents), you may call the National Pesticide Information Center at 1-800-858-7378, from 8:00 a.m. to 12:00 p.m. Pacific time Mon.-Fri. After 12:00 p.m. Pacific Time on weekdays, and during the weekend, call the poison center at 1-800-222-1222

Country	Organisation/Company	Address	Emergency number	Comment
United States of America	National Pesticide Information Center	Oregon State University 310 Weniger Hall Corvallis, OR 97331-6502	1.800.858.7378	

SECTION 2: Hazards identification

2.1. Classification of the substance or mixture

Classification according to Regulation (EC) No. 1272/2008 [CLP] Mixtures/Substances: SDS EU 2015: According to Regulation (EU) 2015/830 (REACH Annex II)

Respiratory sensitisation, Category 1 H334
Skin sensitisation, Category 1 H317
Hazardous to the aquatic environment — Acute Hazard, Category 1 H400
Hazardous to the aquatic environment — Chronic Hazard, Category 1 H410
Full text of H statements: see section 16

Adverse physicochemical, human health and environmental effects

No additional information available

2.2. Label elements

Labelling according to Regulation (EC) No. 1272/2008 [CLP]

Hazard pictograms (CLP) :



GHS08

GHS09

Signal word (CLP) : Warning
Hazardous ingredients : Beauveria bassiana
Hazard statements (CLP) : H334 - May cause allergy or asthma symptoms or breathing difficulties if inhaled.
H410 - Very toxic to aquatic life with long-lasting effects.
Precautionary statements (CLP) : P261 - Avoid breathing dust/fume/gas/mist/vapours/spray.
P272 - Contaminated work clothing should not be allowed out of the workplace.
P273 - Avoid release to the environment.
P280 - Wear cold insulating gloves/face shield/eye protection.
P284 - Wear respiratory protection.
P302+P352 - IF ON SKIN: Wash with plenty of water.

2.3. Other hazards

No additional information available

SECTION 3: Composition/information on ingredients**3.1. Substances**

Not applicable

3.2. Mixtures

Name	Product identifier	%	Classification according to Regulation (EC) No. 1272/2008 [CLP]
2-(1-methyl-2-(4-phenoxyphenoxy)ethoxy)pyridine	(CAS-No.) 95737-68-1 (EC-No.) 429-800-1 (EC Index-No.) 613-303-00-3	74.03	Aquatic Acute 1, H400 Aquatic Chronic 1, H410
Silicon Dioxide	(CAS-No.) 7631-86-9 (EC-No.) 231-545-4 (REACH-no) 01-2119379499-16	15.97	Not classified
Beauveria bassiana	(CAS-No.) 63428-82-0	10	Resp. Sens. 1, H334 Skin Sens 1, H317

Full text of H-statements: see section 16

SECTION 4: First aid measures**4.1. Description of first aid measures**

First-aid measures general	: Never give anything by mouth to an unconscious person. If you feel unwell, seek medical advice (show the label where possible).
First-aid measures after inhalation	: If breathing is difficult, remove the victim to fresh air and keep at rest in a position comfortable for breathing. If experiencing respiratory symptoms: Call a POISON CENTER/doctor.
First-aid measures after skin contact	: Remove affected clothing and wash all exposed skin areas with mild soap and water, followed by a warm water rinse. Wash with plenty of water/.... If skin irritation or rash occurs: Get medical advice/attention. Specific treatment (see supplemental first aid instruction on this label). Wash contaminated clothing before reuse.
First-aid measures after eye contact	: Rinse immediately with plenty of water. Obtain medical attention if pain, blinking or redness persists.
First-aid measures after ingestion	: Rinse mouth. Do NOT induce vomiting. Obtain emergency medical attention.

4.2. Most important symptoms and effects, both acute and delayed

Symptoms/effects after inhalation	: May cause allergy or asthma symptoms or breathing difficulties if inhaled. It may cause an allergic skin reaction.
-----------------------------------	--

4.3. Indication of any immediate medical attention and special treatment needed

No additional information available

SECTION 5: Firefighting measures**5.1. Extinguishing media**

Suitable extinguishing media	: Foam. Dry powder. Carbon dioxide. Water spray. Sand.
Unsuitable extinguishing media	: Do not use a heavy water stream.

5.2. Special hazards arising from the substance or mixture

No additional information available

5.3. Advice for firefighters

Firefighting instructions	: Use water spray or fog for cooling exposed containers. Exercise caution when fighting any chemical fire. Prevent firefighting water from entering the environment.
Protection during firefighting	: Do not enter the fire area without proper protective equipment, including respiratory protection.

SECTION 6: Accidental release measures**6.1. Personal precautions, protective equipment and emergency procedures****6.1.1. For non-emergency personnel**

Emergency procedures	: Evacuate unnecessary personnel.
----------------------	-----------------------------------

6.1.2. For emergency responders

Protective equipment	: Equip the cleanup crew with proper protection.
Emergency procedures	: Ventilate area.

6.2. Environmental precautions

Prevent entry to sewers and public waters. Notify authorities if liquid enters sewers or public waters. Avoid release to the environment.

6.3. Methods and material for containment and cleaning up

Methods for cleaning up	: On land, sweep or shovel into suitable containers. Minimize the generation of dust. Store away from other materials.
-------------------------	--

6.4. Reference to other sections

See Heading 8. Exposure controls and personal protection.

In2mix

Safety Data Sheet

according to Regulation (EC) No. 1907/2006 (REACH) with its amendment Regulation (EU) 2015/830

SECTION 7: Handling and storage

7.1. Precautions for safe handling

Precautions for safe handling	: Wash hands and other exposed areas with mild soap and water before eating, drinking or smoking and when leaving work. Provide good ventilation in the process area to prevent the formation of vapour. Avoid breathing dust/fume/gas/mist/vapours/spray.
Hygiene measures	: Contaminated work clothing should not be allowed out of the workplace. Wash contaminated clothing before reuse.

7.2. Conditions for safe storage, including any incompatibilities

Storage conditions	: Keep the container closed when not in use. Store in a dry, cool, well-ventilated area. Keep only in the original container in a cool, well-ventilated place away from :
Incompatible products	: Strong bases. Strong acids.
Incompatible materials	: Sources of ignition. Direct sunlight.

7.3. Specific end use(s)

No additional information available

SECTION 8: Exposure controls/personal protection

8.1. Control parameters

No additional information available

8.2. Exposure controls

Personal protective equipment:

Avoid all unnecessary exposure.

Eye protection:

Chemical goggles or safety glasses

Respiratory protection:

In case of inadequate ventilation, wear respiratory protection.

Other information:

Do not eat, drink or smoke during use.

SECTION 9: Physical and chemical properties

9.1. Information on basic physical and chemical properties

Physical state	: Solid
Colour	: Off-white.
Odour	: characteristic.
Odour threshold	: No data available
pH	: 6.46
Relative evaporation rate (butylacetate=1)	: No data available
Melting point	: No data available
Freezing point	: No data available
Boiling point	: No data available
Flash point	: No data available
Auto-ignition temperature	: No data available
Decomposition temperature	: No data available
Flammability (solid, gas)	: Non-flammable.
Vapour pressure	: No data available
Relative vapour density at 20 °C	: No data available
Relative density	: No data available
Density	: 0.457 g/cm ³
Solubility	: No data available
Log Pow	: No data available
Viscosity, kinematic	: No data available
Viscosity, dynamic	: No data available
Explosive properties	: No data available
Oxidising properties	: No data available
Explosive limits	: No data available

9.2. Other information

No additional information available

In2mix

Safety Data Sheet

according to Regulation (EC) No. 1907/2006 (REACH) with its amendment Regulation (EU) 2015/830

SECTION 10: Stability and reactivity

10.1. Reactivity

Stable under normal conditions.

10.2. Chemical stability

Not established.

10.3. Possibility of hazardous reactions

Not established.

10.4. Conditions to avoid

Direct sunlight. Extremely high or low temperatures.

10.5. Incompatible materials

Strong acids. Strong bases.

10.6. Hazardous decomposition products

Fume. Carbon monoxide. Carbon dioxide.

SECTION 11: Toxicological information

11.1. Information on toxicological effects

Acute toxicity (oral) : According to OCSPP 870.1100 study, the LD50 of the test substance In2Mix was determined to be greater than 5000 mg/kg bw and, therefore, not classified.

Acute toxicity (dermal) : According to OCSPP 870.1200 study, the LD50 of the test substance In2Mix was determined to be greater than 5050 mg/kg bw and, therefore, not classified.

Acute toxicity (inhalation) : According to OCSPP 870.1300 and OECD 403 study, the LC50 of the test substance In2Mix was determined to be greater than 2.12mg/ and therefore not classified.

2-(1-methyl-2-(4-phenoxyphenoxy)ethoxy)pyridine (95737-68-1)

LD50 oral rat	> 5000 mg/kg
LD50 dermal rat	> 5050 mg/kg
LC50 inhalation rat	> 2.12 mg/L

Skin corrosion/irritation

:According to the results, In2mix was considered not sensitizing to guinea pigs' skin, SKIN sensitization GUINEA PIG OECD 406.
Under the test conditions, the test substance In2Mix was not classified into the GHS categories and class IV by ANVISA.

Acute dermal irritation/corrosion Rabbits OECD 404 pH

:According to OECD 404, no dermal irritation signs were observed in In2mix.
: 6.46

Additional information

:Based on available data, the classification criteria are not met

Serious eye damage/irritation

:According to the results, In2mix was moderately irritating but not classified.

Additional information

:Based on available data, the classification criteria are not met

Respiratory or skin sensitization

:Based on OCSPP 870.2600 guideline test, In2mix produced no reaction in any animal.
:In2mix is not a sensitizer in guinea pigs.
:May cause allergy or asthma symptoms or breathing difficulties if inhaled. May cause an allergic skin reaction.

Additional information

: Inhaling may cause allergy, asthma symptoms, or breathing difficulties.
It may cause an allergic skin reaction.

Germ cell mutagenicity

: Not classified

Additional information

: Based on available data, the classification criteria are not met

Carcinogenicity

: Not classified

Additional information

: Based on available data, the classification criteria are not met

Reproductive toxicity

: Not classified

Additional information

: Based on available data, the classification criteria are not met

STOT-single exposure

: Not classified

Additional information

: Based on available data, the classification criteria are not met

STOT-repeated exposure

: Not classified

Additional information

: Based on available data, the classification criteria are not met

Aspiration hazard

: Not classified

Additional information

: Based on available data, the classification criteria are not met

Potential adverse human health effects and symptoms : The product contains *Beauveria bassiana* and is considered skin and respiratory sensitizing.

In2mix

Safety Data Sheet

according to Regulation (EC) No. 1907/2006 (REACH) with its amendment Regulation (EU) 2015/830

SECTION 12: Ecological information

12.1. Toxicity

Ecology - water : Very toxic to aquatic life. Very toxic to aquatic life with long lasting effects.
Acute aquatic toxicity : Very toxic to aquatic life.
Chronic aquatic toxicity : Very toxic to aquatic life with long lasting effects.

2-(1-methyl-2-(4-phenoxyphenoxy)ethoxy)pyridine (95737-68-1)

LC50 fish 1	96h: 0.45 mg/l Oncorhynchus mykiss (Rainbow trout)
EC50 Daphnia 1	48h: 0.4 mg/l

12.2. Persistence and degradability

In2mix

Persistence and degradability : May cause long-term adverse effects in the environment.

12.3. Bioaccumulative potential

In2mix

Bioaccumulative potential : Not established.

12.4. Mobility in soil

No additional information available

12.5. Results of PBT and vPvB assessment

No additional information available

12.6. Other adverse effects

Additional information : Avoid release to the environment.

SECTION 13: Disposal considerations

13.1. Waste treatment methods



Product/Packaging disposal recommendations : Dispose safely in accordance with local/national regulations. hazardous or special waste collection point in accordance with local, regional, national and/or international regulation.

Ecology - waste materials : Avoid release to the environment.

SECTION 14: Transport information

In accordance with ADR / RID / IMDG / IATA / ADN

ADR	IMDG	IATA
Special provision(s) applied : 375	Special provision(s) applied : 969	Special provision(s) applied : A197
14.1. UN number		
3077	3077	3077
14.2. UN proper shipping name		
ENVIRONMENTALLY HAZARDOUS SUBSTANCE, SOLID, N.O.S. (2-(1-methyl-2-(4-phenoxyphenoxy)ethoxy)pyridine(95737-68-1))	ENVIRONMENTALLY HAZARDOUS SUBSTANCE, SOLID, N.O.S. (2-(1-methyl-2-(4-phenoxyphenoxy)ethoxy)pyridine(95737-68-1))	Environmentally hazardous substance, solid, n.o.s. (2-(1-methyl-2-(4-phenoxyphenoxy)ethoxy)pyridine(95737-68-1))
Transport document description		
UN 3077 ENVIRONMENTALLY HAZARDOUS SUBSTANCE, SOLID, N.O.S. (2-(1-methyl-2-(4-phenoxyphenoxy)ethoxy)pyridine(95737-68-1)), 9, III, (E)	UN 3077 ENVIRONMENTALLY HAZARDOUS SUBSTANCE, SOLID, N.O.S. (2-(1-methyl-2-(4-phenoxyphenoxy)ethoxy)pyridine(95737-68-1)), 9, III	UN 3077 Environmentally hazardous substance, solid, n.o.s. (2-(1-methyl-2-(4-phenoxyphenoxy)ethoxy)pyridine(95737-68-1)), 9, III
14.3. Transport hazard class(es)		
9	9	9

		
14.4. Packing group		
III	III	III
14.5. Environmental hazards		
Dangerous for the environment : Yes	Dangerous for the environment : Yes Marine pollutant : Yes	Dangerous for the environment : Yes
Environmentally hazardous substances derogation applies (quantity of liquids ≤ 5 litres or net mass of solids ≤ 5 kg)		
No supplementary information available		

14.6. Special precautions for user**Overland transport**

Classification code (ADR) : M7
 Excepted quantities (ADR) : E1
 Packing instructions (ADR) : P002, IBC08, LP02, R001
 Special packing provisions (ADR) : PP12, B3
 Mixed packing provisions (ADR) : MP10
 Portable tank and bulk container instructions (ADR) : T1, BK1, BK2
 Portable tank and bulk container special provisions (ADR) : TP33

Tank code (ADR) : SGAV, LGBV
 Vehicle for tank carriage : AT
 Transport category (ADR) : 3
 Special provisions for carriage - Packages (ADR) : V13
 Special provisions for carriage - Bulk (ADR) : VC1, VC2
 Special provisions for carriage - Loading, unloading and handling (ADR) : CV13

Hazard identification number (Kemler No.) : 90
 Orange plates :



Tunnel restriction code (ADR) : E
 EAC code : ZZ

Transport by sea

Stowage and handling (IMDG) : SW23

Air transport

No data available

14.7. Transport in bulk according to Annex II of Marpol and the IBC Code

Not applicable

SECTION 15: Regulatory information**15.1. Safety, health and environmental regulations/legislation specific for the substance or mixture****15.1.1. EU-Regulations**

Contains no REACH substances with Annex XVII restrictions
 Contains no substance on the REACH candidate list
 Contains no REACH Annex XIV substances
 Directive 2012/18/EU (SEVESO III)

15.1.2. National regulations

91720-1 EPA registration number

In2mix

Safety Data Sheet

according to Regulation (EC) No. 1907/2006 (REACH) with its amendment Regulation (EU) 2015/830

15.2. Chemical safety assessment

No chemical safety assessment has been carried out

SECTION 16: Other information

Data sources : REGULATION (EC) No 1272/2008 OF THE EUROPEAN PARLIAMENT AND OF THE COUNCIL of 16 December 2008 on classification, labelling and packaging of substances and mixtures, amending and repealing Directives 67/548/EEC and 1999/45/EC, and amending Regulation (EC) No 1907/2006.

Other information : None.

Full text of H- and EUH-statements:	
Aquatic Acute 1	Hazardous to the aquatic environment — Acute Hazard, Category 1
Aquatic Chronic 1	Hazardous to the aquatic environment — Chronic Hazard, Category 1
Resp. Sens. 1	Respiratory sensitisation, Category 1
Skin Sens. 1	Skin sensitisation, Category 1
H317	May cause an allergic skin reaction.
H334	May cause allergy or asthma symptoms or breathing difficulties if inhaled.
H400	Very toxic to aquatic life.
H410	Very toxic to aquatic life with long-lasting effects.

SDS EU (REACH Annex II)

DISCLAIMER OF LIABILITY The information in this SDS was obtained from sources which we believe are reliable. However, the information is provided without any warranty, express or implied, regarding its correctness. The conditions or methods of handling, storage, use or disposal of the product are beyond our control and may be beyond our knowledge. For this and other reasons, we do not assume responsibility and expressly disclaim liability for loss, damage or expense arising out of or in any way connected with the handling, storage, use or disposal of the product. This SDS was prepared and is to be used only for this product. If the product is used as a component in another product, this SDS information may not be applicable.